

BEFORE THE ILLINOIS POLLUTION CONTROL BOARD

Ringger Farms, Inc.-Gridley )  
(Property Identification Number ) PCB 011-  
02-01-300-004 ) (Tax Certification)  
)  
)

NOTICE

Clerk  
Illinois Pollution Control Board  
James R. Thompson Center  
100 West Randolph Street, Suite. 11-500  
Chicago, Illinois 60601

Stan Ringger  
29288 N 2025 E Road  
Gridley, Illinois 61774

Steve Santarelli  
Illinois Department of Revenue  
101 West Jefferson  
Post Office Box 19033  
Springfield, Illinois 62794

**PLEASE TAKE NOTICE** that I have today filed with the Office of the Clerk of the Pollution Control Board an **APPEARANCE AND THE RECOMMENDATION** of the Illinois Environmental Protection Agency, a copy of which is herewith served upon you.

ENVIRONMENTAL PROTECTION AGENCY  
OF THE STATE OF ILLINOIS

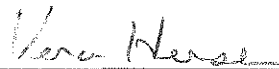
By:   
Vera Herst  
Assistant Counsel  
Division of Legal Counsel

DATED: June 17, 2011

Illinois Environmental Protection Agency  
1021 North Grand Avenue East  
Post Office Box 19276  
Springfield, Illinois 62794-9276  
(217) 782-5544

**THIS FILING IS SUBMITTED ON RECYCLED PAPER**

BEFORE THE ILLINOIS POLLUTION CONTROL BOARD

Ringger Farms, Inc.-Gridley )  
(Property Identification Number ) PCB 011-  
02-01-300-004) (Tax Certification)  
)  
)

A P P E A R A N C E

The undersigned, as one of its attorneys, hereby enters an APPEARANCE on behalf of Respondent, Illinois Environmental Protection Agency.

ILLINOIS ENVIRONMENTAL PROTECTION AGENCY

By: Vera Herst  
Vera Herst  
Assistant Counsel  
Division of Legal Counsel

DATED: June 17, 2011  
Illinois Environmental Protection Agency  
1021 North Grand Avenue East  
Post Office Box 19276  
Springfield, Illinois 62794-9276  
(217)782-5544

THIS FILING IS SUBMITTED ON RECYCLED PAPER

BEFORE THE ILLINOIS POLLUTION CONTROL BOARD

Ringger Farms, Inc. )  
(Property Identification Number ) PCB 011-  
02-01-300-004) (Tax Certification)  
)  
)

RECOMMENDATION

The Illinois Environmental Protection Agency ("Illinois EPA") hereby files its Recommendation pursuant to Section 125.204 of the regulations of the Illinois Pollution Control Board, 35 Ill. Adm. Code 125.204.

1. On January 20, 2010, the Illinois EPA received a request from Ringger Farms, Inc. (log number TC-02-10, Exhibit A) for an Illinois EPA recommendation regarding the tax certification of water pollution control facilities pursuant to 35 Ill. Adm. Code 125.204.
  
2. The applicant's address is: Stan Ringger  
29288 N 2025 E Road  
Gridley, Illinois 61774
  
3. The proposed water pollution control facilities in this request are located at SW 1/4 Section 1, T26N, R2E of the 3rd PM in McLean County, at the above street address and consist of the following:

Livestock waste management facilities consisting of one concrete manure pit (approximately 200 ft. x 50 ft. x 8 ft. deep) and slotted concrete portion of the floor over the manure pit and 4 pumpout ports (6 ft. x 6ft. and 8 ft. each) used to pump out manure.

These livestock waste management facilities are used to collect, transport and/or store livestock wastes prior to cropland application, and are further described in Exhibit A.

**THIS FILING IS SUBMITTED ON RECYCLED PAPER**

4. Section 11-10 of the Property Tax Code, 35 ILCS 200/11-10 (2010), defines “pollution control facilities” as:

“any system, method, construction, device or appliance appurtenant thereto or any portion of any building or equipment, that is designed, constructed, installed or operated for the primary purpose of: (a) eliminating, preventing, or reducing air or water pollution ...or (b) treating, pretreating, modifying or disposing of any potential solid, liquid or gaseous pollutant which if released without treatment, pretreatment modification or disposal might be harmful, detrimental or offensive to human, plant or animal life, or to property.”

5. Pollution control facilities are entitled to preferential tax treatment, 35 ILCS 200/11-5.
6. Based on the information in the application and the purpose of the facilities, it is the Illinois EPA’s engineering judgment that the described facilities may be considered “pollution control facilities,” pursuant to 35 Ill. Adm. Code 125.200(a), with the primary purpose of eliminating, preventing, or reducing water pollution, or as otherwise provided in 35 Ill. Adm. Code 125.200, and are eligible for tax certification from the Board.

WHEREFORE, the Illinois EPA recommends that the Board issue the

requested tax certification.

ILLINOIS ENVIRONMENTAL  
PROTECTION AGENCY

By: Vera Herst  
Vera Herst  
Assistant Counsel  
Division of Legal Counsel

Dated: June 17, 2011  
Illinois Environmental Protection Agency  
1021 North Grand Ave. E.  
P.O. Box 19276  
Springfield, Illinois 62794-9276  
217/782-5544



ILLINOIS ENVIRONMENTAL PROTECTION AGENCY

1021 North Grand Avenue East, P.O. Box 19276, Springfield, Illinois 62794-9276 • (217) 782-2829  
James R. Thompson Center, 100 West Randolph, Suite 11-300, Chicago, IL 60601 • (312) 814-6026

PAT QUINN, GOVERNOR

DOUGLAS P. SCOTT, DIRECTOR

# Memorandum

To: Connie Tonsor, Division of Legal Counsel

From: Al Keller, P.E., Manager, Permit Section *AK*

Date: May 27, 2011

Re: Ringger Farms Inc. - Gridley  
Recommendation of Tax Certification  
Log # TC-02-10  
Property Identification # 02-01-300-004

The Bureau of Water received a request on January 20, 2010 from Stan Ringger for an Illinois EPA recommendation regarding the tax certification of water pollution control facilities pursuant to 35 Il. Adm. Code 125.204. We offer the following recommendation.

The water pollution control facilities in this request include the following:

Ringger Farms, Inc.  
29288 N 2025 E Rd.  
Gridley, IL 61774  
Attn: Stan Ringger

SW 1/4 Section 1, T26N, R2E of the 3<sup>rd</sup> PM in McLean County

Livestock waste management facilities consisting of one concrete manure pit (approximately 200 ft. x 50 ft. x 8 ft. deep) and slotted concrete portion of the floor over the manure pit and 4 pumpout ports (6 ft. x 6ft. and 8 ft. each) used to pump out manure.

These livestock waste management facilities are used to collect, store and/or transport livestock wastes prior to cropland application.

These facilities are further described in the enclosed applications and supporting documents.

Based on the information included in this submittal, it is our engineering judgment that the above proposed facilities may be considered "Pollution Control Facilities" under 35 IAC 125.200(a), with the primary purpose of eliminating, preventing, or reducing water pollution, or as otherwise provided in this section, and therefore eligible for tax certification from the Illinois Pollution Control Board. The Bureau of Water therefore recommends that the Board issue the requested tax certification for these facilities.

If you have any questions regarding the above, please contact Raj Ojha at 217/782-3362.

SAK:RKO:TC-02-10

\*\*\*\*\* PCB 2011-096 \*\*\*\*\*

Project Name: Ringger Farms, Inc.  
Reviewer: RJS  
Log No.: PC-02-10

Location: Gridley  
Date: 04/15/11  
Type:  Agchem  
 Livestock

Applicant: Ringger Farms, Inc.  
29258 N 2025 E Rd  
Gridley, IL 61744  
Attn: Stan Ringer

Contact: Stan Ringer  
Phone: 309 747 2604

Facility: Same as Applicant

Property ID: 02-01-300-004

Legal Description:

County: McHenry

Date Control Devices Installed:

Provided Fair Cash Value: \$133,500

Signature: by Owner on the Application

Title: Owner

- Wastes:
- Livestock waste is applied to cropland.
  - Agrichemical rinsate and spillage is recycled through the facility and/or land applied.
  - Other:

Physical Description of Pollution Control Devices: 200 ft x 50 ft x 8 ft deep manure pit with manual ports used to pump manure to crop land where it is injected.  
+ Per telephone call from Stan Ringer, 4 pumpout (6' x 6' x 8' deep)

Other:

TC-00-10

APPLICATION FOR CERTIFICATION (PROPERTY TAX TREATMENT)  
 POLLUTION CONTROL FACILITY  
 AIR  WATER

ILLINOIS ENVIRONMENTAL PROTECTION AGENCY  
 P. O. Box 19276, Springfield, IL 62794-9276

This Agency is authorized to request this information under Illinois Revised Statutes, 1979, Chapter, 120, Section 502a-5. Disclosure of this information is voluntary. However, failure to comply could prevent your application from being processed or could result in denial of your application for certification.

FOR AGENCY USE

File No.	Date Received	Certification No.	Date
APPLICANT	Sec. A Company Name <i>Ringger Farms Inc.</i>		
	Person Authorized to Receive Certification <i>Stan Ringger</i>		Person to Contact for Additional Details <i>SAME</i>
	Street Address <i>29288 N 2025 E Rd</i>		Street Address
	Municipality, State & Zip Code <i>Gridley IL 61744</i>		Municipality, State & Zip Code
	Telephone Number <i>309 747-2604</i>		Telephone Number <i>SAME</i>
	Location of Facility Quarter Section Township <i>SW 1/4 Gridley</i> Range <i>3 EAST</i>		Municipality Township <i>Gridley Gridley</i>
	Street Address <i>23294 E 3100 N Rd</i>		County Book Number <i>McLean</i>
	Property Identification Number <i>02-01-300-004</i>		Parcel Number <i>02-01-300-004</i>
	MANUFACTURING OPERATIONS	Sec. B Nature of Operations Conducted at the Above Location <i>pork production</i> <i>Finishing manure</i>	
Water Pollution Control Construction Permit No.		Date Issued	
NPDES PERMIT No.		Date Issued	Expiration Date
Air Pollution Control Construction Permit No.		Date Issued	
Air Pollution Control Operating Permit No.		Date Issued	
MANUFACTURING PROCESS	Sec. C Describe Unit Process		
	Materials Used in Process		
POLLUTION CONTROL FACILITY DESCRIPTION	Sec. D Describe Pollution Abatement Control Facility		<p>* Surface water runs <del>to</del> South East 1/2 miles to Buck creek                  This structure eliminates runoff</p>

RECEIVED  
 JAN 20 2010

ILLINOIS ENVIRONMENTAL PROTECTION AGENCY  
 BOW/WPC/PERMIT SECTION

injected.



Sec. E	(1) Nature of Contaminants or Pollutants		
POLLUTION CONTROL FACILITY - CONTAMINANTS		Material Retained, Captured or Recovered	
	Contaminant or Pollutant	DESCRIPTION	DISPOSAL OR USE
	<i>Swine manure</i>	<i>Finishing manure</i>	<i>injected for fertilizer</i>
ACCOUNTING DATA	(2) Point(s) of Waste Water Discharge		
	Plans and Specifications Attached		Yes <input type="checkbox"/> No <input type="checkbox"/>
	(3)	Are contaminants (or residues) collected by the control facility?	Yes <input checked="" type="checkbox"/> No <input type="checkbox"/>
	(4)	Date installation completed <u>9/01/09</u> status of installation on date of application <u>in operation</u>	
	(5)	a. FAIR CASH VALUE IF CONSIDERED REAL PROPERTY:	\$ <u>133,500</u>
		b. NET SALVAGE VALUE IF CONSIDERED REAL PROPERTY:	\$ <u>10,000</u>
		c. PRODUCTIVE GROSS ANNUAL INCOME OF CONTROL FACILITY:	\$ <u>300,000</u>
		d. PRODUCTIVE NET ANNUAL INCOME OF CONTROL FACILITY:	\$ <u>36,000</u>
		e. PERCENTAGE CONTROL FACILITY BEARS TO WHOLE FACILITY VALUE:	% <u>48%</u>
Sec. F	The following information is submitted in accordance with the Illinois Property Tax Code, as amended, and to the best of my knowledge, is true and correct. The facilities claimed herein are "pollution control facilities" as defined in Section 11-10 of the Illinois Property Tax Code.		
SIGNATURE			
	Signature	<u>President</u> Title	
Sec. G	INSTRUCTIONS FOR COMPILING AND FILING APPLICATION		
	General: Separate applications must be completed for each control facility claimed. Do not mix types (water and air). Where both air and water operations are related, file two applications. If attachments are needed, record them consecutively on an index sheet.		
INSTRUCTIONS	Sec. A	Information refers to applicant as listed in the tax records and the person to be contacted for further details or for inspection of facilities. Define facility location by street address or legal description. A plat map location is required for facilities located outside of municipal boundaries. The property identification number is required.	
	Sec. B	Self-explanatory. Submit copies of all permits issued by local pollution control agencies. (e.g. MSD Construction Permit)	
	Sec. C	Refers to manufacturing processes or materials on which pollution control facility is used.	
	Sec. D	Narrative description of the pollution control facility, indicating that its primary purpose is to eliminate, prevent or reduce pollution. State the type of control facility. State permit number, date, and agency issuing permit. A narrative description and a process flow diagram describing the <u>pollution control facility</u> . Include a listing of each major piece of equipment included in the claimed fair cash value for real property. Include an <u>average</u> analysis of the influent and effluent of the control facility stating the collection efficiency.	
	Sec. E	List air contaminants, or water pollution substances released as effluents to the manufacturing processes. List also the final disposal of any contaminants removed from the manufacturing processes. Item (1) - Refers to pollutants and contaminants removed from the process by the pollution control facility. Item (2) - Refers to water pollution but can apply to water-carried wastes from air pollution control facilities. Submit drawings, which clearly show (a) Point(s) of discharge to receiving stream, and (b) Sewers and process piping to and from the control facility. Item (3) - If the collected contaminants are disposed of other than as wastes, state the disposition of the materials, and the value in dollars reclaimed by sale or reuse of the collected substances. State the cost of reclamation and related expense. Item (4) - State the date which the pollution control facility was first placed in service and operated. If not, explain. Item (5) - This information is essential to the certification and assessment actions. This accounting data must be completed to activate project review prior to certification by this Agency.	
	Sec. F	Self-explanatory. Signature must be a corporate authorized signature.	
		Submit to:	Attention:
		Illinois EPA P.O. Box 19276 Springfield, IL 62794-9276	AI Keller Permit Section Division of Water Pollution Control
			Donald E. Sutton Permit Section Division of Air Pollution Control

EAST PART GRIDLEY

T.26N.-R.3E.

LIVINGSTON COUNTY

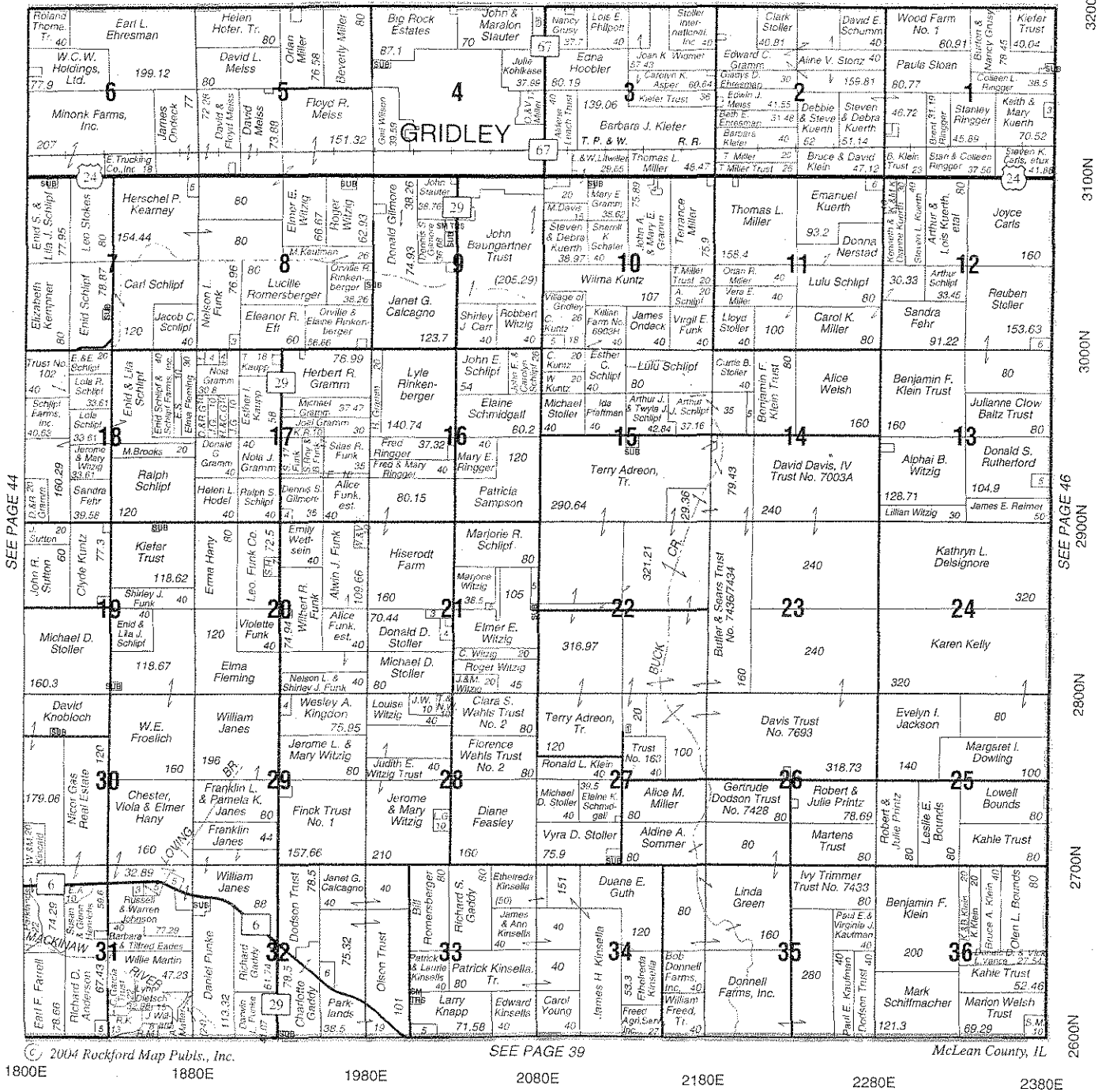

© 2004 Rockford Map Pubs., Inc.

SEE PAGE 39

McLean County, IL

1800E

1880E

1980E

2080E

2180E

2280E

2380E

SOIL TESTING



CROP SCOUTING

645 East 9th Road  
Wenona, IL 61377

Office: (815) 853-1006  
Fax: (815) 853-1007

STATE OF ILLINOIS

COUNTY OF SANGAMON

)  
)  
)  
)  
)

**PROOF OF SERVICE**

I, the undersigned attorney at law, hereby certify that on June 17, 2011, I served true and correct copies of an APPEARANCE AND THE RECOMMENDATION, upon the persons and by the methods as follows:

**[1<sup>st</sup> Class U.S. Mail]**

Steve Santarelli  
Illinois Department of Revenue  
101 West Jefferson  
Post Office Box 19033  
Springfield, Illinois 62794

**[1<sup>st</sup> Class U.S. Mail]**

Stan Ringger  
29288 N 2025 E Road  
Gridley, Illinois 61774

**[Electronic Filing]**

Clerk  
Illinois Pollution Control Board  
James R. Thompson Center  
100 West Randolph Street, Suite. 11-500  
Chicago, Illinois 60601

ILLINOIS ENVIRONMENTAL PROTECTION AGENCY

/s/ Vera Herst  
Assistant Counsel  
Division of Legal Counsel  
1021 North Grand Avenue East  
P.O. Box 19276-  
Springfield, Illinois 62794-9276  
217.782.5544  
217.782.9143 (TDD)

**THIS FILING IS SUBMITTED ON RECYCLED PAPER**